



SERVICE PARTS LIST

BULLETIN NO.
54-06-9950

SPECIFY CATALOG NO. AND SERIAL NO. WHEN ORDERING PARTS		REVISED BULLETIN	DATE
18 VOLT WORKLIGHT			Mar. '98
CATALOG NO. 49-24-0160	STARTING SERIAL NO. 970A	WIRING INSTRUCTION See Below	

EXAMPLE:

00	0
----	---

 Component Parts (Small #) Are Included When Ordering The Assembly (Large #).

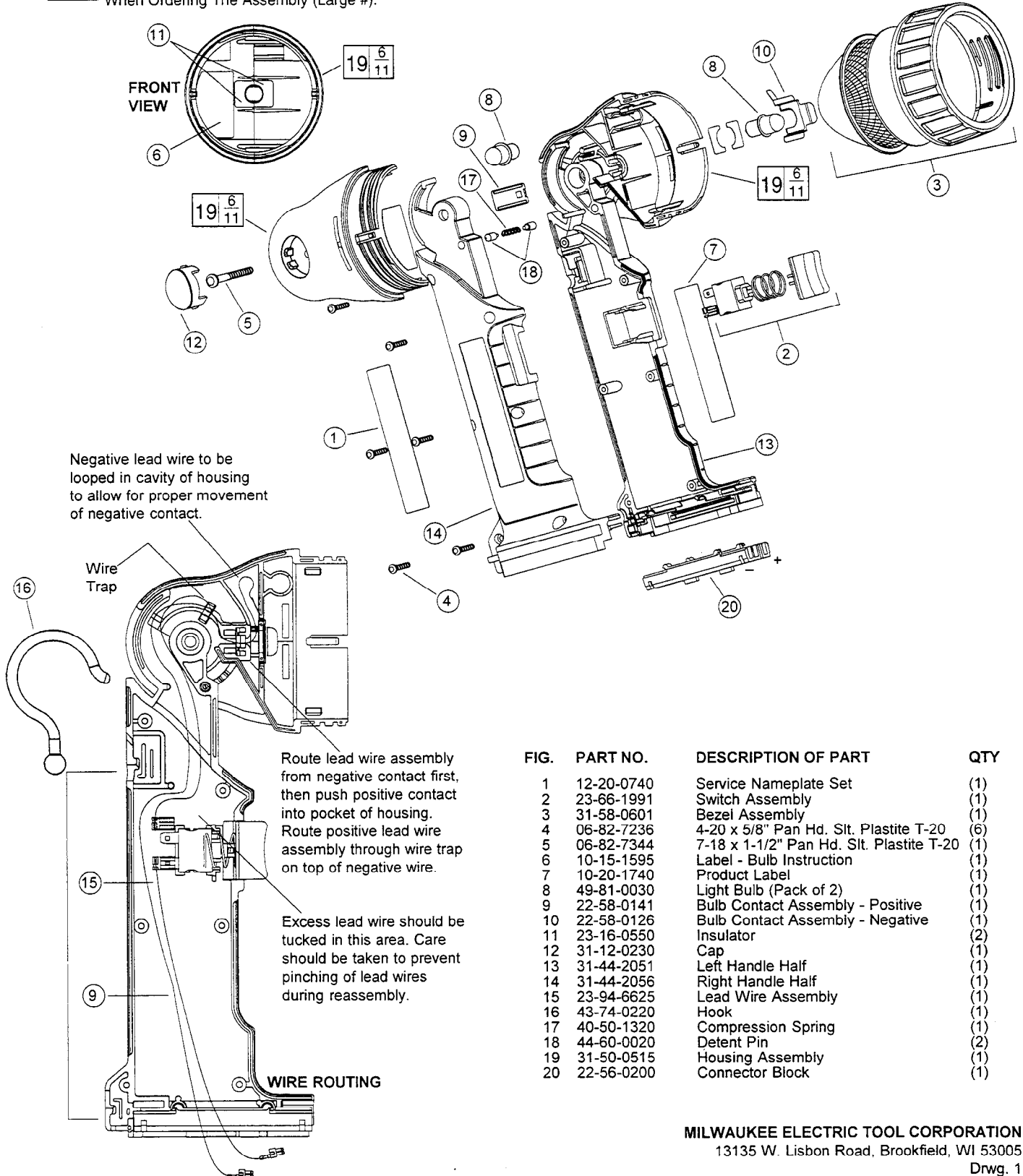

FIG.	PART NO.	DESCRIPTION OF PART	QTY
1	12-20-0740	Service Nameplate Set	(1)
2	23-66-1991	Switch Assembly	(1)
3	31-58-0601	Bezel Assembly	(1)
4	06-82-7236	4-20 x 5/8" Pan Hd. Slit. Plastite T-20	(6)
5	06-82-7344	7-18 x 1-1/2" Pan Hd. Slit. Plastite T-20	(1)
6	10-15-1595	Label - Bulb Instruction	(1)
7	10-20-1740	Product Label	(1)
8	49-81-0030	Light Bulb (Pack of 2)	(1)
9	22-58-0141	Bulb Contact Assembly - Positive	(1)
10	22-58-0126	Bulb Contact Assembly - Negative	(1)
11	23-16-0550	Insulator	(2)
12	31-12-0230	Cap	(1)
13	31-44-2051	Left Handle Half	(1)
14	31-44-2056	Right Handle Half	(1)
15	23-94-6625	Lead Wire Assembly	(1)
16	43-74-0220	Hook	(1)
17	40-50-1320	Compression Spring	(1)
18	44-60-0020	Detent Pin	(2)
19	31-50-0515	Housing Assembly	(1)
20	22-56-0200	Connector Block	(1)

MILWAUKEE ELECTRIC TOOL CORPORATION
 13135 W. Lisbon Road, Brookfield, WI 53005
 Drwg. 1