

TECHNICAL INFORMATION



PRODUCT

P 1 / 4

Model No. ▶ 3707FC, 3708FC

Description ▶ Trimmers

CONCEPT AND MAIN APPLICATIONS

The above models have slimmer bodies for easy to grip, comparing with the existing model 3703 and 3704.

Their further features are :

- 3707FC :
- * Adjusting roller for fine-adjustment of cutting depth precisely.
 - * LED Job Light is installed for lighting up at working point.
 - * Electronic features for speed control for keeping constant speed under the loaded condition and soft start for suppressing starting shock.

3708FC : Equipped with adjustable trimmer base angle for obtaining desired cutting angle, in addition to the features of 3707FC,

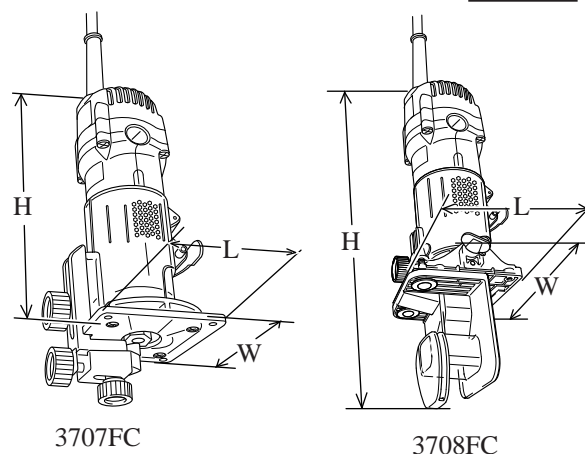

Dimensions : mm (")		
Model No.	3707FC	3708FC
Length (L)	90 (3-1/2)	103 (4-1/16)
Height (H)	204 (8)	308 (12-1/2)
Width (W)	90 (3-1/2)	117 (4-13/16)

► Specification

Voltage (V)	Current (A)	Cycle (Hz)	Continuous Rating (W)		Max. Output(W)
			Input	Output	
110	4.8	50/60	500	150	500
120	4.4	50/60	500	150	500
230	2.3	50/60	500	150	500

Model No.)	3707FC	3708FC
No load speed : (min -1= rpm)	26,000	26,000
Collet capacity	6 mm or 6.35 mm (1/4")	6 mm or 6.35 mm (1/4")
Stroke of trimmer head : mm (")	35 (1-3/8)	35 (1-3/8)
Adjustment of trimmer base angle		0° - 45°
LED Job Light	Yes	Yes
Electronic features for	Soft starter	Yes
	Speed control	Yes
Protection from electric shock	by double insulation	by double insulation
Net weight :Kg (lbs)	1.2 (2.6)	1.3 (2.9)
Cord length : m (ft)	2.5 (8.2)	2.5 (8.2)

► Standard equipment

- * Trimmer guide assembly 1 pc.
- * Straight guide 1 pc.
- * Templet guide 1 pc.
- * Wrench 10 1 pc.
- * Wrench 17 1 pc.
- * T.C.T. Straight bit 1 pc.

< Note > The standard equipment for the tool shown may differ from country to country.

► Optional accessories

- * Various router bits
- * Straight guide
- * Trimmer guide assembly
- * Trimmer shoe
- * Collet cone 6mm
- * Collet cone 1/4"
- * Templet guide
- * Trimmer base assembly
- * Flexible hose
- * Joint

► **Features and benefits**

Ergonomically designed motor housing provides easier and more comfortable gripping than competitors.

Diameter of gripping portion

3707 series model : 60mm (2-3/8")

3703 series model : 65mm (2-9/16")

Competitor's Model A: 64mm (2-1/2")

Length of gripping portion

3707 series model : 107mm (4-1/4")

3703 series model : 103mm (4-1/16")

Competitor's Model A: 64mm (2-1/2")

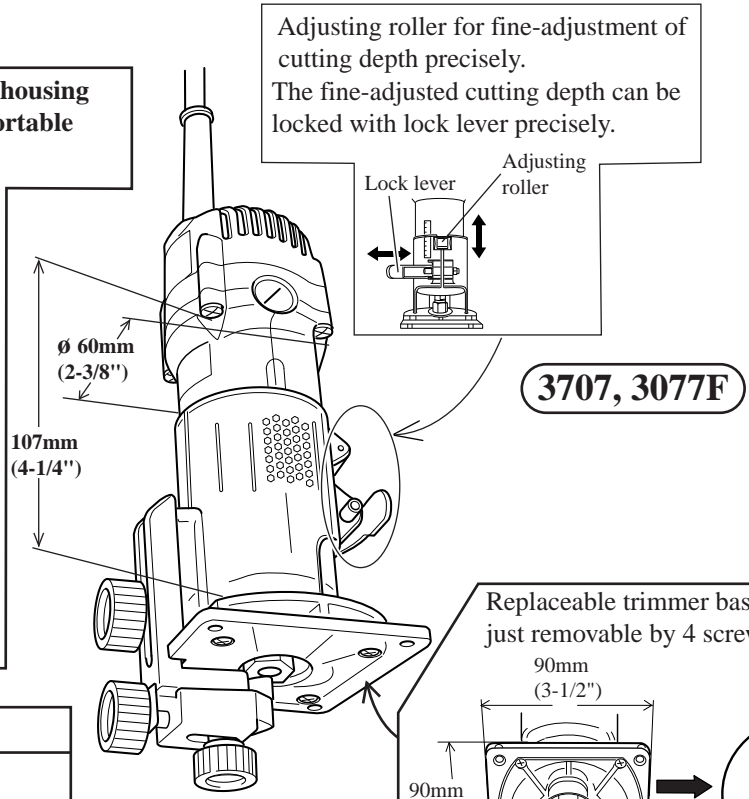

Adjusting roller for fine-adjustment of cutting depth precisely. The fine-adjusted cutting depth can be locked with lock lever precisely.

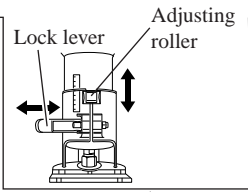

3707, 3077F

Replaceable trimmer base just removable by 4 screws.

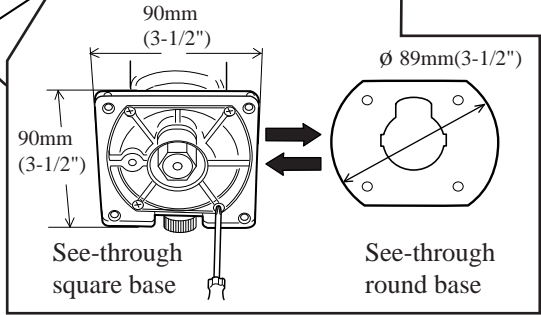

For 3707F and 3708F

LED Job light for lighting up at working point in shadow

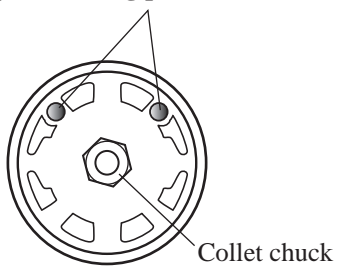

Bottom view of motor housing

Adjusting roller for fine-adjustment of cutting depth precisely. The fine-adjusted cutting depth can be locked with lock lever precisely.

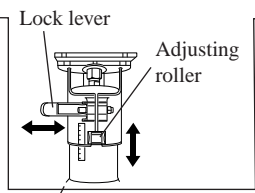

3708, 3708F

Adjustable trimmer base angle for obtaining desired cutting angle. (Only 3708 and 3708F)

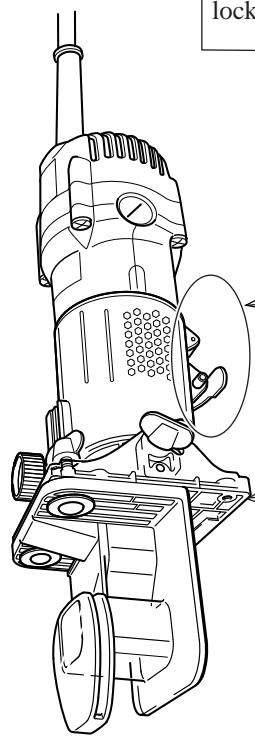
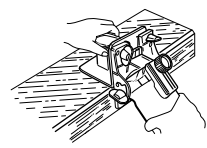

Model No.		Non angle-adjustable base		Angle-adjustable base
		MAKITA	Competitor A	MAKITA
		3707FC	Model A	3708FC
Specifications				
Power input : W		500	500	500
No load speed : (min -1= rpm)		26,000	24,000	26,000
Collet capacity		6 mm / 6.35 mm (1/4")	6 mm	6 mm / 6.35 mm (1/4")
Protection from electric shock		by double insulation	by double insulation	by double insulation
LED Job Light		Yes	No	Yes
Fein-adjustment of base		Yes	Yes	Yes
Dimensions : mm (")	Length	90 (3-1/2)	90 (3-1/2)	103 (4-1/16)
	Width	90 (3-1/2)	90 (3-1/2)	117 (4-13/16)
	Height	204 (8)	210 (8-1/4)	308 (12-1/2)
Net weight :Kg (lbs)		1.2 (2.6)	1.3 (2.9)	1.3 (2.9)

► Repair

< Assembling armature of commutator side >

< Note in assembling >

1. Do not assemble the used self lock. The self lock has to be always replaced with the fresh one.
2. Pay attention to the assembling direction of self lock and wave washer 6. See Fig. 1
3. The magnet sleeve is installed to the armature shaft on commutator side for sensing the variation of rotating speed. If it would be damaged, the electronic speed control does not work any more. So, applying 1R026 " Bearing setting pipe" to self lock, press it with your hand, instead of with arbor press.

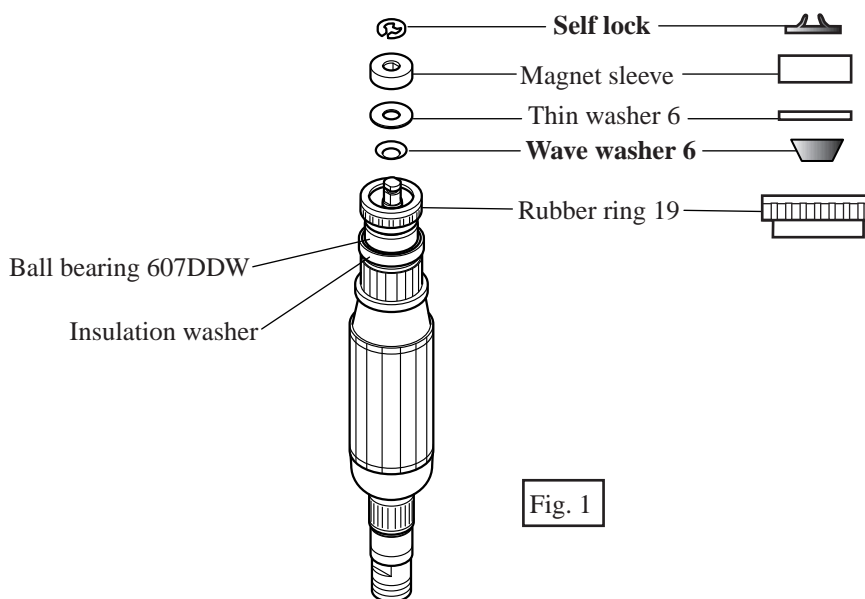
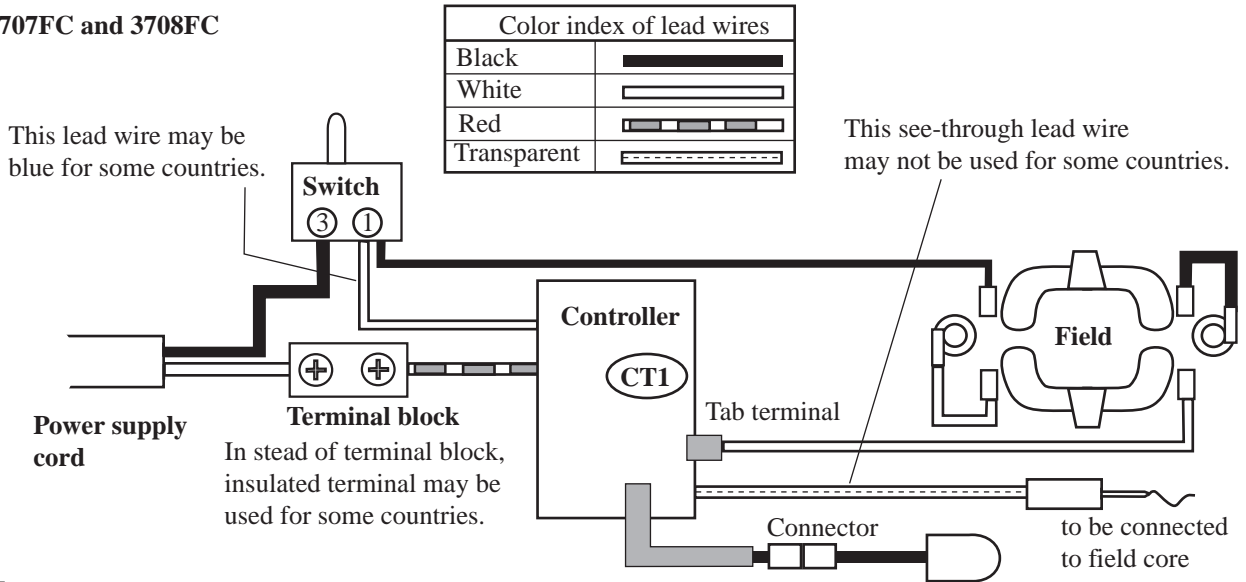

Fig. 1

▶ Circuit diagram

3707FC and 3708FC



▶ Wiring diagram

3707F and 3708F with LED Job light

