

T ECHNICAL INFORMATION



New Tool

Models No. ▶ 5094D, 5094DWA

Description ▶ MAKITA Cordless Circular saw

CONCEPT AND MAIN APPLICATIONS

Model 5094D is 14.4V version of the existing Model 5093D.

The working volume per one charge is increased.

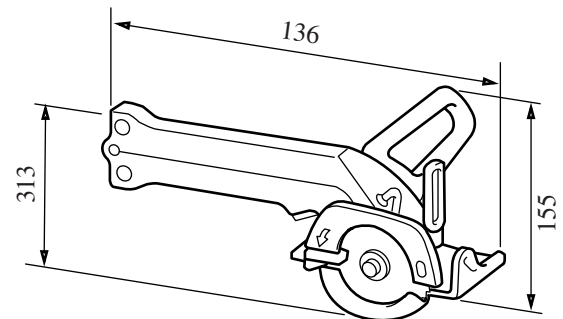

► Specifications

Motor	DC 14.4 V magnet motor
No load speed (R.P.M.)	1000/min.
Max. cutting depth	0-24.5 mm in the right angle, 0 -18 mm in beveling at 45°
Inner diameter	15 mm
Net weight	2.1 kg(Battery included)

► Standard equipment

Saw blade 85mm (Mounted on the body)

Hex. spanner 4

► Optional accessories

Reffer General catalogue

► Features and benefits

- (1) The bevel cutting function enables to cut at 45° for jointing.
(Others are the same as 5081D.)
- (2) The battery power source permits the application without troubling with the power cord.
- (3) The cartridge type battery assures the continuous operation by replacing with the spare battery.
- (4) Once the safety lock built-in the switch has been set, it does not allow the saw cutter to start turning by an accidentally switching.

The standard equipment for the tools shown may differ form country to country

► Comparison

Battery 1422 (14.4V) enables to get more working volume than the existing Model 5091D and Model 5093D.

Specifications		Makita				
		5094D	5091D	5092D	5093D	5090D
Battery	Voltage (V)	14.4	12	12	12	9.6
	Type	1422 (Push Button)	1201 (Set Plate)	1210 (Set Plate)	1222 (Push Button)	9000 (Set Plate)
	Capacity (Ah)	2.0	1.7	1.3	2.0	1.3
No load speed (rpm)		1,000	1,000	1,000	1,000	1,000
Blade	Diameter (mm)	285(3-3/8")	285(3-3/8")	285(3-3/8")	285(3-3/8")	285(3-3/8")
	Innner Diameter (mm)	15(9/16")	15(9/16")	15(9/16")	15(9/16")	15(9/16")
	Kind of Blade	TCT	TCT	TCT	TCT	Combination
	No. of teeth	20	20	20	20	50
Bevel Angle		0 - 45 degree	0 - 45 degree	0 - 45 degree	0 - 45 degree	0 - 45 degree
Cutting (mm)	At 90 degree	24.5(15/16")	24.5(15/16")	24.5(15/16")	24.5(15/16")	22(7/8")
	At 45 degree	18(11/16")	18(11/16")	18(11/16")	18(11/16")	18(11/16")
Lock Off						
Weight (including battery)		2.1Kg (4.6lbs)	2.1Kg (4.6lbs)	2.1Kg (4.6lbs)	2.1Kg (4.6lbs)	21.8Kg(4.0lbs)
Standard Equipment		Rip Fence Hex Wrench TCT.Blade 20T	Rip Fence Hex Wrench TCT.Blade 20T	Rip Fence Hex Wrench TCT.Blade 20T	Rip Fence Hex Wrench TCT.Blade 20T Set Plate	Hex Wrench CombinationBlade 50T

Conditions

1. The ability of Model 5091D/5093D is to be indexed for 100.
2. Full charged 2.0Ah batteries are installed in the testing machines.
3. Work piece is plywood with thickness, 12mm.

Cutting Speed

0 Slow Fast 100

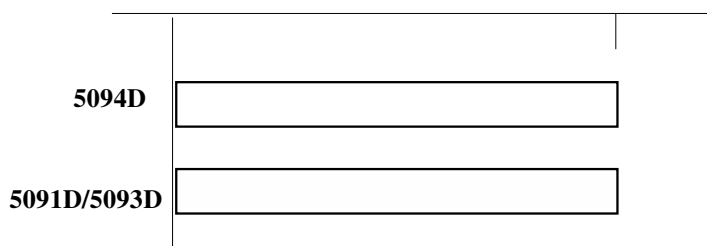

Working Volume per one Charge

