

For Models ▶ 9060L

Description ▶ 180mm Angle Sander

CONCEPTION AND MAIN APPLICATIONS

The machines are disc grinders with a size of 180mm/230mm(7"/9") which are competitive in price and have been developed as mass-market items in #9049 Series .

Comparing to #9049, the volume was decreased and Torque limiter was removed by suppressing Maximum output for the purpose of lighter weight and lower price.

#9067S/ 9069S are #9067/9069 with Soft start.

#9067L is #9067 of which speed is lower.

All the models here are for only export.

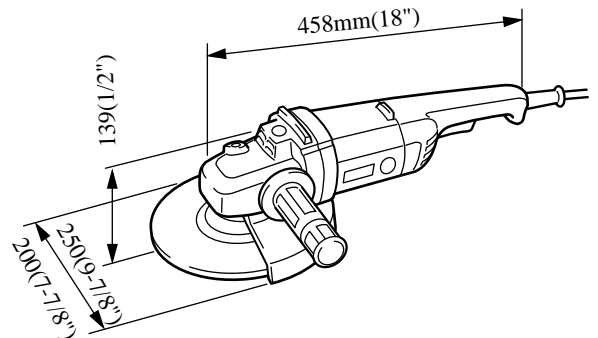

► Specifications

Voltage (V)	Current(A)	Cycle(Hz)	Continuous Rating(W)		Max. output(W)
			input	output	
115	15	50/60	1650	900	2600
220	9.6	50/60	2000	1100	2600
230	9.2	50/60	2000	1100	2600
240	8.8	50/60	2000	1100	2600

Motor		Series commutator motor (S94-45 load)
No Load Speed	9067/9067S	8500 R/min.
	9067L/9069/9069S	6600 R/min.
	9067L/9069 (for only USA and Canada)	6000 R/min.
Depressed center wheel	9067/9067L/9067S	Outer dia. 180, Inner dia. 22.23(mm) Thickness 6
	9069/9069S	Outer dia. 230, Inner dia. 22.23(mm) Thickness 6

► Standard equipment

Lock nut wrench35 (for general export)

Lock nut wrench28 (9067L/9069: for only U.S.A.)

► Optional accesories

9067/9067L/9067S:

Inner flange (for general export)

Grinding wheel24P/36P, Inner flange78 (for cutting wheel)

Outer flange78 (for cutting wheel)

Wire cup brush 110 set, Grip set (loop handle)

9069/9069S:

Inner flange47 set (for general export)

Grinding wheel24P/36P (for cutting wheel)

Outer flange78 (for cutting wheel)

Wire cup brush110 set, Grip set (loop handle)

Wheel cover for collecting dusts

Large spindle lock

Shape is suitable for handling easily with hands in gloves

Long life motor

Effective thickness of segment in commutator is made as twice thick as the former one. Also, Zigzag varnish is applied to protect motor from both dissipated heat and dust particles.

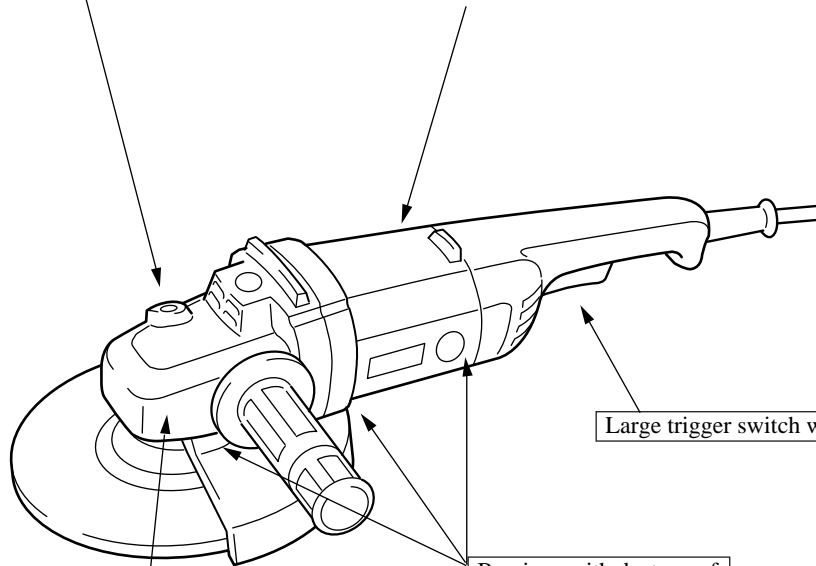

Large trigger switch with good operativity

Bearings with dust-proof

side/ Fan side of Armature and Bearing in Bearing box of Spindle are made dust-proof, and Labyrinth structure (maze structure against dusts) is applied.

Gear housing attachable , rotating every 90°

► **Comparison of products**

Spec.	Model	MAKITA				STAYER		BOSCH
	with soft start	9067 9067L	9069	9047 9047L	9049	SA12A	SA10A	PWS20-230
	without soft start	9067S	9069S	9047S	9049S	SA12AL	SA10AL	PWS20-230J
Wheel diameter(mm)		180(7")	230(9")			←		23019
*1 Consuming power(W)		2,000		2,300		2,000		2,000
*1 Load axis lock torque(kgf.cm)		360		560		300		340
Load axis rotation (rpm)		(9067 9067S) 8,500 (9069 9069S 9067L) 6,600	(9047 9047S) 8,500 (9049 9049S 9047L) 6,600			8,500	6,500	6,500
Torque limiter		×		○		×		×
Spindle lock		○		←		←		←
Noise without load(db)		91		90		93		93
Grip attach position		Upper right/left 3 points		←		Upper right/left 3 points		Upper right/left 3 points
*2 Weight (kg/lbs)	Machine	4.2		4.8		4.2		4.2
	Without grinding wheel	9.3		10.6		9.3		9.3
		4.9	5.1	5.5	5.8	4.9	5.1	5.1
		10.8	11.2	12.1	12.8	10.8	11.2	11.2

*1 Comparison in Spec. 230V

*2 Weight:

•Machine weight means the weight without Wheel, Wheel cover, Inner flange, Lock nut grip, Power supply cord.

•"Without grinding wheel" means the weight without Power supply cord and Depressed center wheel.

3. Exchange of Armature

- 1) Remove Grinding wheel and Wheel cover each.
- 2) Remove Carbon brush.
- 3) Remove Tapping screws fixing Gear housing and Motor housing.

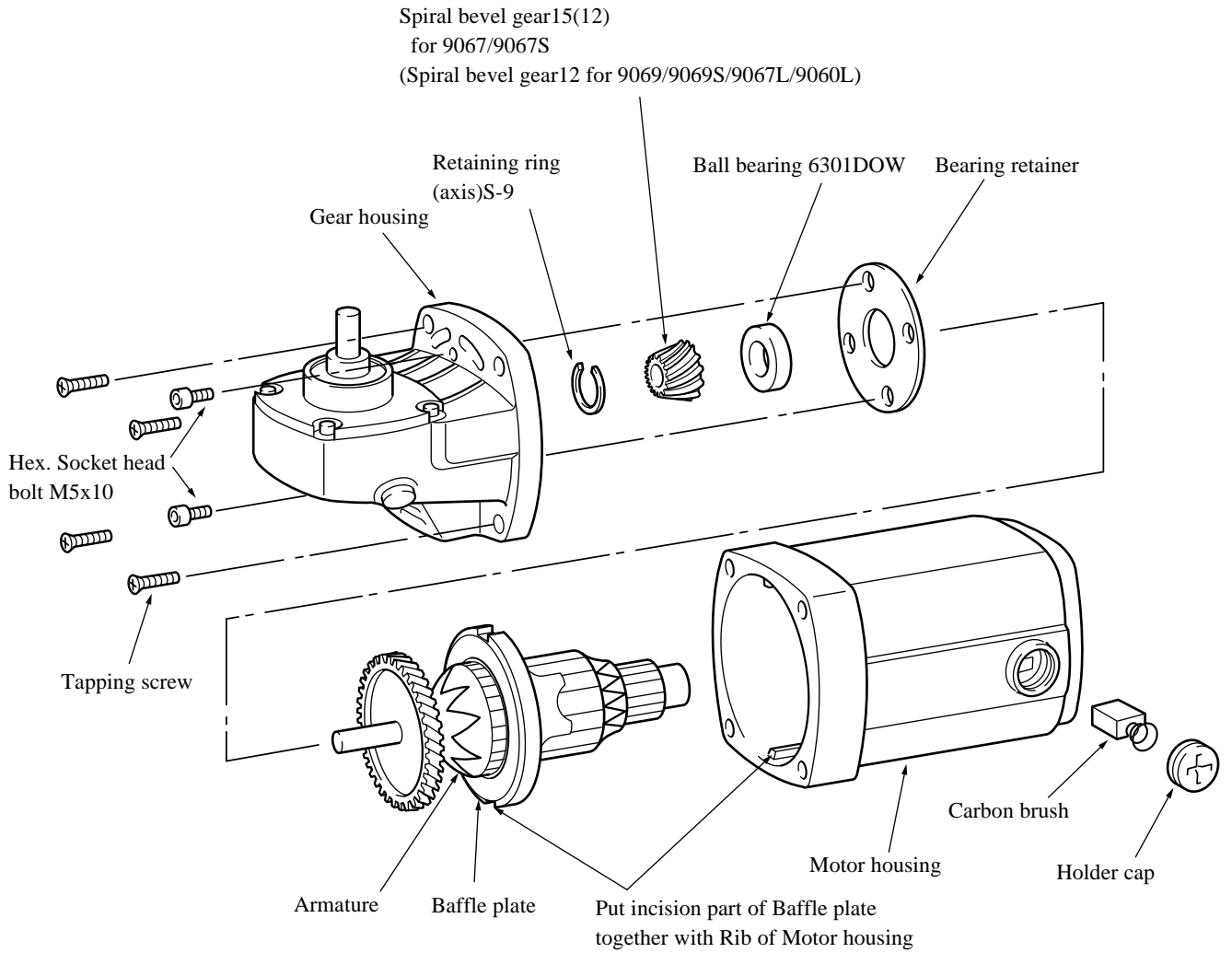

▶ Wiring diagram

<9067S, 9069S>

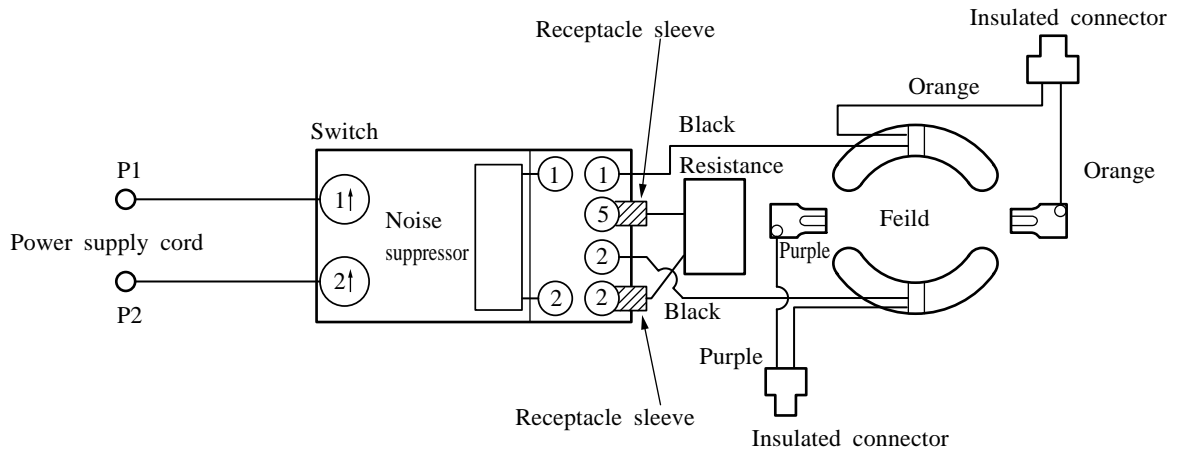

<9067, 9069, 9060L, 9067L>

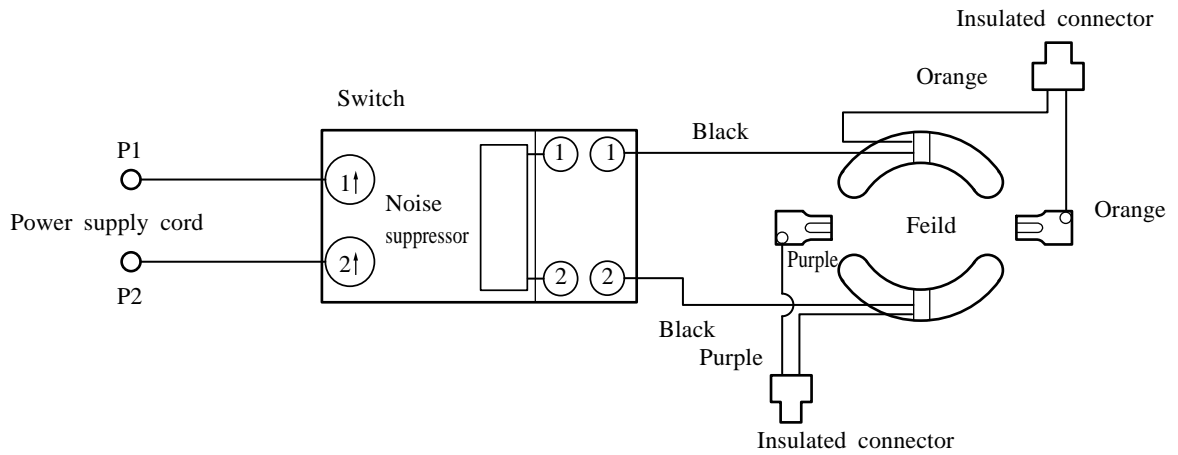

(NOTE) Noise suppressor is not used in some areas.