

For Models ▶ LS1030

Description ▶ Miter Saw

CONCEPTION AND MAIN APPLICATIONS

A new 255mm(10") miter saw with price advantage. A less expensive version of our current model LS1020. The newly designed blade cover for more safety and the wider guide rule with a narrower center slit. (See features / benefits bellow) Electric brake for quick stopping of blade.

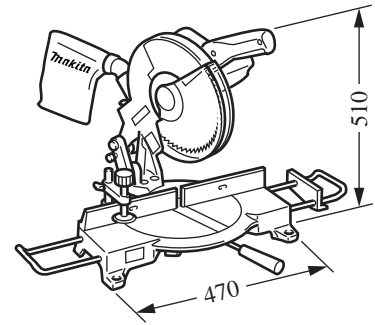

▶ Specifications

Voltage (V)	Current(A)	Cycle(Hz)	Rating Output (W)	Max. output(W)
100	14.0	50/60	750	1,800
115	12.0	50/60	750	1,800
200	7.0	50/60	750	1,800
220	6.5	50/60	750	1,800
230	6.0	50/60	750	1,800
240	6.0	50/60	750	1,800
Net Weight			10.6kgs. (21.2lbs.)	
No Load Speed			4,600RPM	

▶ Standard equipment

- A dust bag assembly
- A holder set plate
- A set plate
- A box wrench No.13
- A space ring for the blade with 25mm arbor hole.

▶ Optional accessories

- Carbide tipped blade (No.255-11 and No.255-11A)
- Cross cut blade (No.260-2)

► Features and benefits

1. Increased cutting capacities. (without wood facing)
It cuts American standard.
2x4 (38.1mm x 88.9mm = 1-1/2" x 3-1/2") at 45° and
4x4 (88.9mm x 88.9mm = 3-1/2" x 3-1/2") at 90°
2. It weighs only 12.4 kgs. (27.3lbs.) even with standard equipments included.
Very light and easy to carry around.
3. The safety cover starts opening, as the blade comes down.
Easy to get good sight of blade tip and cutting area.
4. A narrower opening between guide fences.
Allows less change to pick up chips and wider fence surface.
5. A large switch lever.
Very easy to operate.
6. Connectable to our vacuum cleaner models 401 or 404.
Dustless operation is available either with the dust bag on with the vacuum cleaner.

► Capacity

Acceptable blade size		255mm to 260mm (10"~10-1/4")
Max. cutting capacities with blade (255mm) on it is	At 90°	70mm x 126mm (2-3/4" x 4-31/32"), 89mm x 89mm (3-1/2" x 3-1/2")
	At 45°	70mm x 89mm (2-3/4" x 3-1/2"), 89mm x 63mm (3-1/2" x 2-1/2")