

# YVB3KTT

## Compact Pressure Trapping Unloader

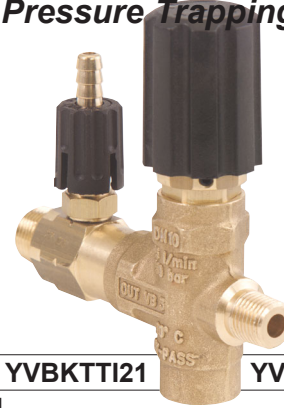

### FEATURES

- Forged Brass Body with Stainless Wetted Parts
- Available With Optional Chemical Injector
- Hexagonal Check for Improved Reliability
- Locking Ring Limits Maximum Pressure Setting

### SPECIFICATIONS

Part Number	YVB3KTT	YVBKTTI18	YVBKTTI21	YVB3KTTI23
Maximum Volume		6.5 GPM		
Maximum Discharge Pressure		3600 PSI		
Maximum Fluid Temperature		195°F		
Inlet Port Thread		1/4" BSP-M		
Discharge Port Thread		3/8" BSP-M		
Bypass Port Thread		3/8" BSP-F		
Weight	1.6 lbs		1.8 lbs	
Dimensions	3.07" x 1.26" x ~4.5"		4.09" x 1.26" x ~4.5"	
Materials	Stainless Steel, Brass, Buna-N, Plastic			

### PARTS LIST

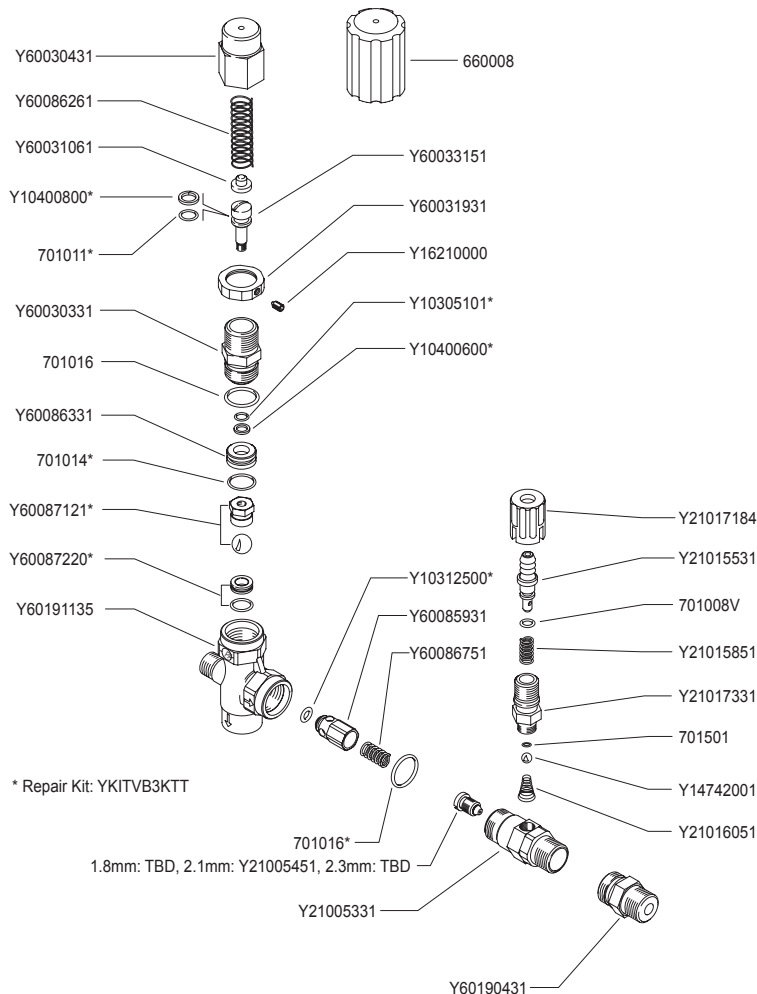

### DIMENSIONS

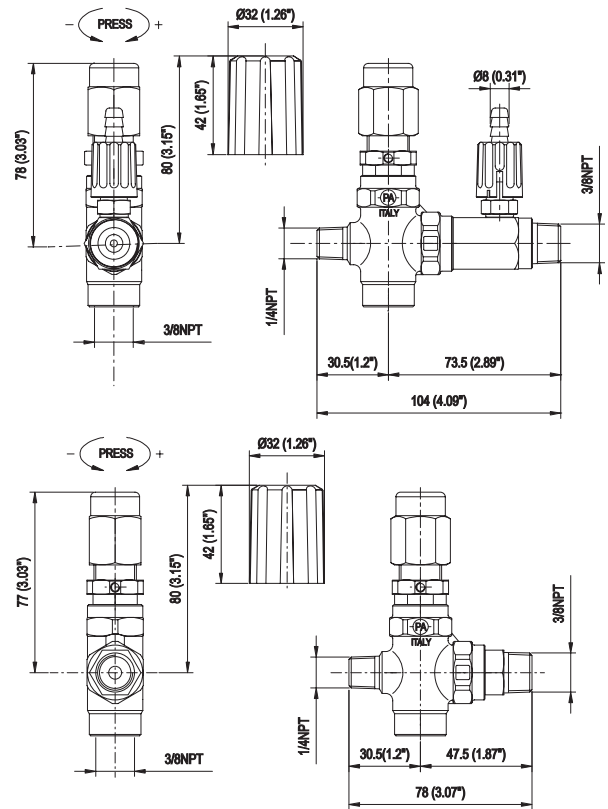

## APPLICATION AND INSTALLATION

### APPLICATION

This product is to be used with clean, fresh water.

For different or corrosive liquids, contact GP Companies Inc. technical support department. With not clean liquids, appropriate filtration should be installed.

Select the valve based on the nominal operating rating: system rated pressure, max flow and max temperature.

Under no circumstances should the pressure of the system exceed the maximum rated pressure of any component.

When installed on hot water cleaners, this valve is to be installed before the boiler.

### INSTALLATION

On a system that produces hot water, consider installing safety devices which limit the accidental increase of the fluid temperature.

Always install a safety valve to protect the operator and system.

Choose a correct nozzle size, able to discharge regularly, on bypass, at least 5% of the total flow of the system, in order to achieve a constant pressure, and avoid troublesome pressure spikes.

When the nozzle wears, the pressure drops. After installing a new nozzle, re-adjust the system to the original pressure setting.

## TROUBLESHOOTING

PROBLEMS	PROBABLE CAUSES	SOLUTIONS
Unloader Cycles	Damaged discharge check valve Leaking fittings or gun Restricted bypass	Replace Check and renew Clean or adapt
Unloader does not come up to pressure	Unloader not properly sized Debris lodged in unloader Unloader piston o-ring worn Worn nozzle	Select proper unloader Clean unloader Replace Replace
Excessive pressure spikes	Unloader improperly adjusted There is not a minimum of 5% flow in bypass	Adjust unloader  Adjust unloader
Unloader won't go into bypass	Discharge check valve jammed Worn discharge check valve o-ring Debris in unloader valve	Clean or replace Replace Clean unloader